

REVISIONS

E.C. NO.	REV.	DESCRIPTION	BY	DATE
	A	DRAWING RELEASED	JP	5/92
1911	B	ADDED PART NUMBERS	KL	3/01

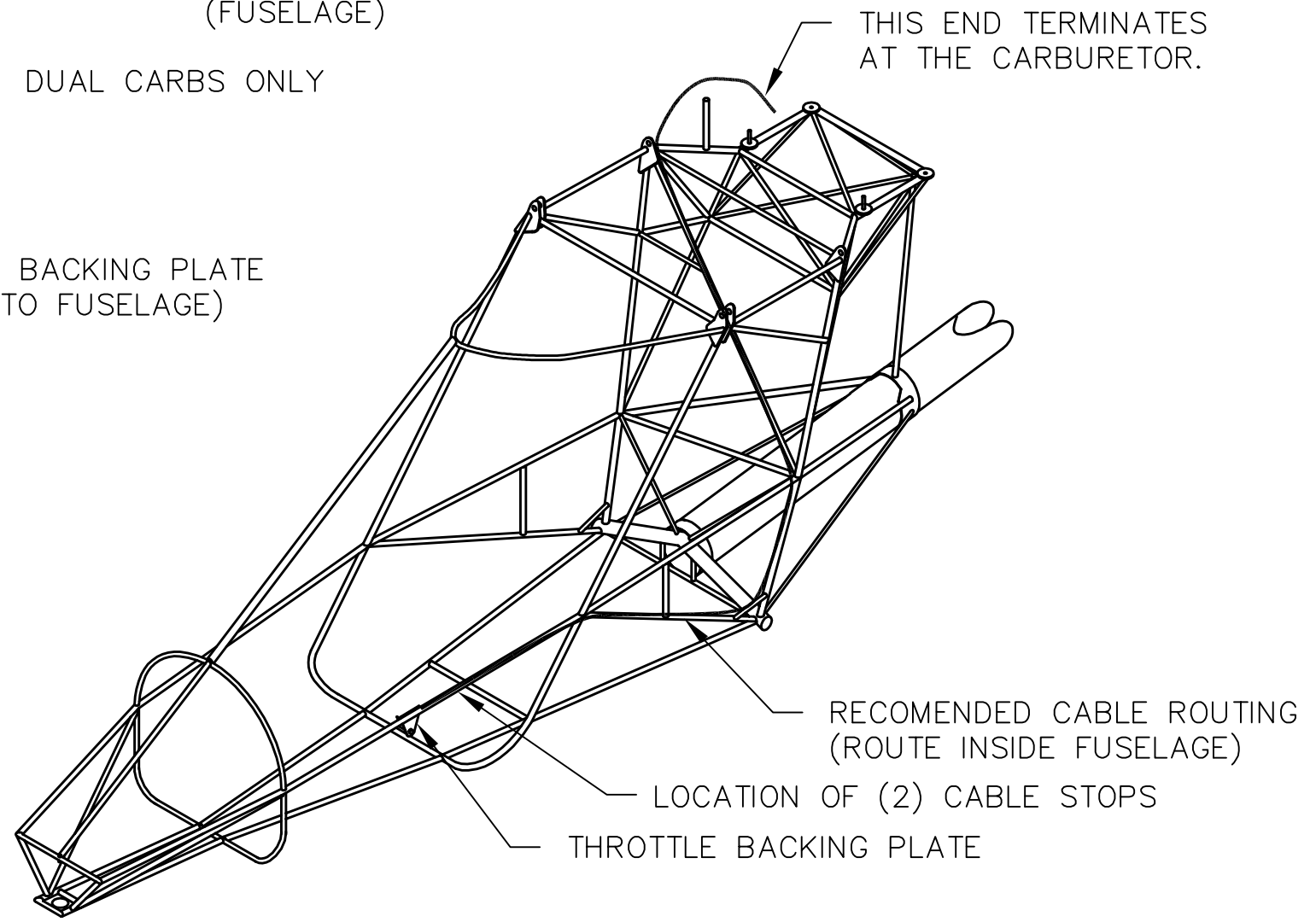
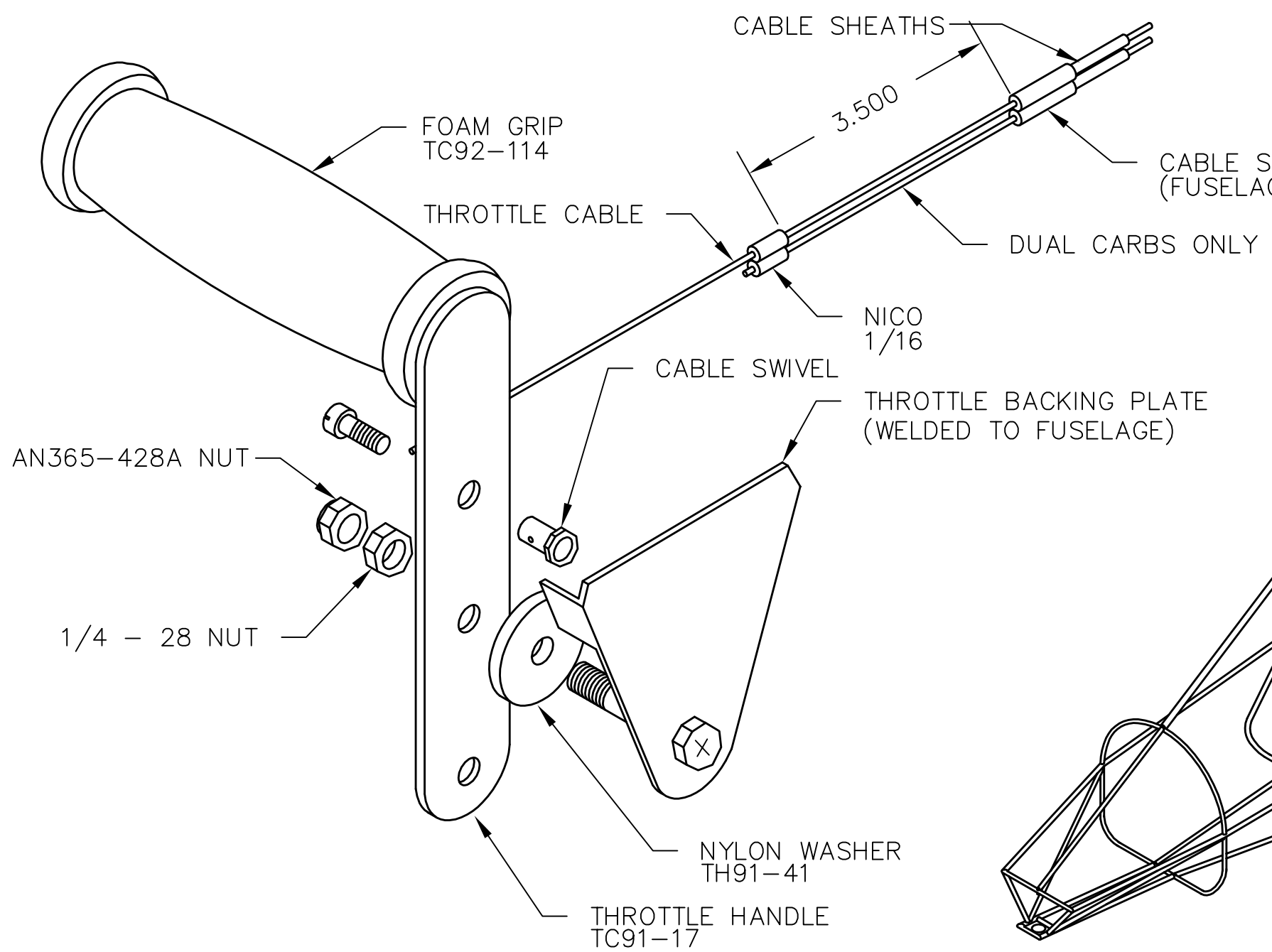

NOTES:

- THROTTLE CABLE IS SHEATHED FROM THE CABLES STOPS TO THE CARBURETOR.
- ENGINES WITH DUAL CARBURETORS GET (2) THROTTLE CABLES. ONLY (1) CABLE IS ATTACHED TO THE THROTTLE HANDLE. NICO PRESS THE OTHER CABLE TO THE FIRST BETWEEN THE CABLE STOPS AND THROTTLE HANDLE.

TITAN AIRCRAFT SUPPLY
 1419 STATE ROUTE 45 SOUTH
 AUSTINBURG, OHIO 44010

DETAIL NAME		THROTTLE HANDLE ASSEMBLY	
SCALE	N/A	PART NO.	N/A
ASSEMBLY NAME		SINGLE SEAT FUSELAGE	
PART NO.	N/A	DRAWING NO.	
DRAWING NO.		B 92-INS-0197-B	

DRAWN	J. PRESTON	DATE	5/15/92
CHECKED	J. PRESTON	DATE	3/24/01
APPROVED	J. PRESTON	DATE	3/24/01

THIS DOCUMENT PROPRIETARY TO TITAN AIRCRAFT, AND IS NOT TO BE USED, CIRCULATED, REPRODUCED, COPIED, OR DISCLOSED IN ANY MANNER WITHOUT PRIOR WRITTEN PERMISSION OF AN AUTHORIZED OFFICIAL OF TITAN AIRCRAFT.