

REVISIONS			
REV.	DESCRIPTION	BY	DATE
B	ADDED OPTIONAL SPACERS	KB	3/96
C	ADDED PART NUMBERS	KL	3/01

- NOTES:
- ALL DIMENSIONS ARE INCHES.
  - SET FLAPS AND AILERONS IN NEUTRAL POSITION. THE TRAILING EDGES OF FLAPS AND AILERONS SHOULD BE IN LINE WITH EACH OTHER.
  - TRIM WINGTIPS TO FIT, INCLUDING CUTOUTS FOR AILERON COUNTER WEIGHT AND AILERON.
  - SLIDE WINGTIPS ONTO THE ENDS OF THE WINGS. THE WINGTIP TRAILING EDGE SHOULD BE EVEN WITH THE TRAILING EDGE OF AILERONS. FOAM WING STANDS MAY BE USED TO HELP HOLD THE WINGTIPS IN PLACE.
  - DRILL ALL RIVET HOLES ON 2.000 INCH CENTERS WITH #30 DRILL (.1285 DIA). RIVET LINES ARE IDENTIFIED BY THE DOTTED LINES. RIVET WITH AD42ABSLF RIVETS. (.125 DIA X .265 LONG)

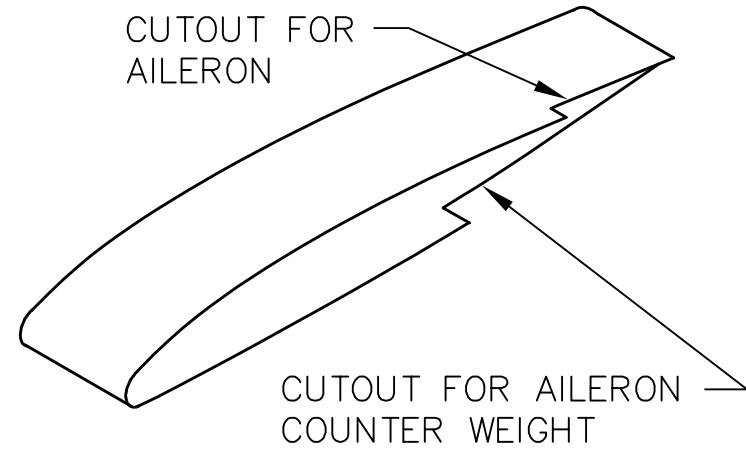

BOTTOM VIEW OF WING

TOP VIEW OF WING

NOTE:  
IF DESIRED,  
FABRICATE SPACER  
PLATES AS SHOWN  
AND USE IN RIB  
INSTALLATIONS  
AT POINT A

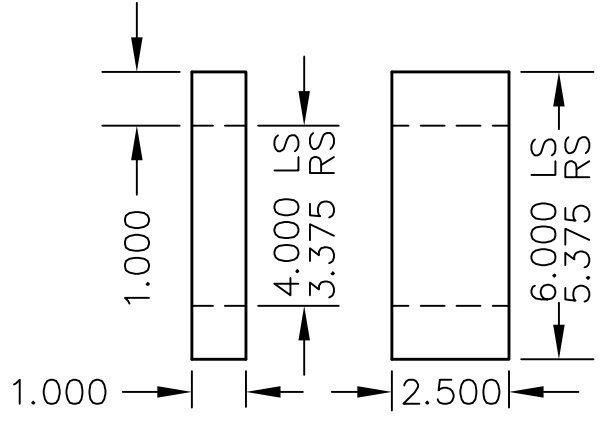
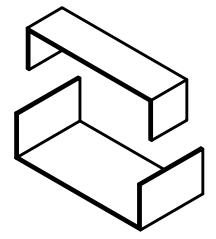

**TITAN AIRCRAFT SUPPLY**  
1419 STATE ROUTE 45 SOUTH  
AUSTINBURG, OHIO 44010

DETAIL NAME		LEFT WINGTIP INSTALLATION	
SCALE	N/A	PART NO.	
ASSEMBLY NAME TORNADO WING ASSEMBLY			
PART NO.		DRAWING NO.	
DRAWING NO.		B 92-INS-0265-C	

DRAWN J. PRESTON	DATE 10/8/92
CHECKED R. INGLE	DATE 3/5/01
APPROVED J. WILLIAMS	DATE 3/5/01

THIS DOCUMENT PROPRIETARY TO TITAN AIRCRAFT, AND IS NOT TO BE USED, CIRCULATED, REPRODUCED, COPIED, OR DISCLOSED IN ANY MANNER WITHOUT PRIOR WRITTEN PERMISSION OF AN AUTHORIZED OFFICIAL OF TITAN AIRCRAFT.