

NOTES:

- THE TAILWHEEL BELLEVILLE DISC SPRINGS (MG13-286) MUST BE INSTALLED WITH THE RAISED AREAS FACING EACH OTHER.

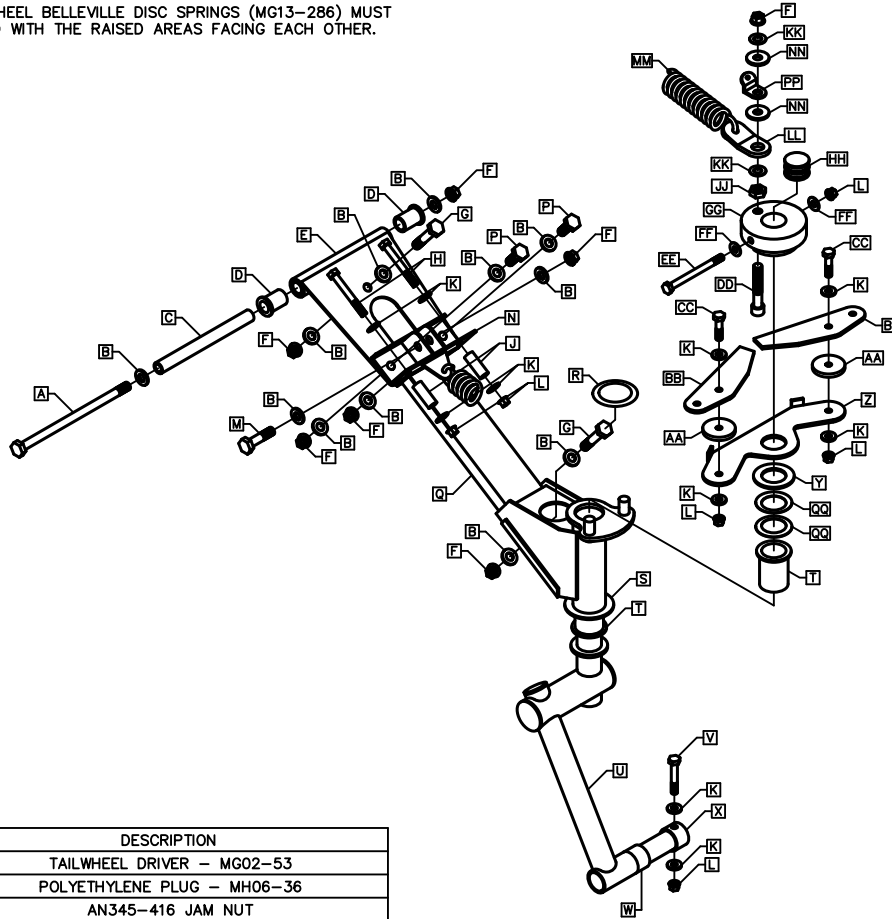

THE DRAWING IS THE PROPERTY OF TITAN AIRCRAFT AND IS NOT TO BE REPRODUCED OR TRANSMITTED IN ANY FORM OR BY ANY MEANS, ELECTRONIC OR MECHANICAL, INCLUDING PHOTOCOPYING, RECORDING, OR BY ANY INFORMATION STORAGE AND RETRIEVAL SYSTEM, WITHOUT THE WRITTEN PERMISSION OF AN AUTHORIZED OFFICIAL OF TITAN AIRCRAFT.

ITEM	QTY	DESCRIPTION
GG	1	TAILWHEEL DRIVER - MG02-53
HH	1	POLYETHYLENE PLUG - MH06-36
JJ	1	AN345-416 JAM NUT
KK	2	AN960-416L THIN WASHER
LL	1	TAILWHEEL CENTERING SPRING MOUNT - MG02-72
MM	1	TAILWHEEL CENTERING SPRING - MG04-207
NN	2	1/4" NYLON WASHER - MH03-11
PP	1	TAILWHEEL AFT OVER CENTER BRACKET - MG06-219
QQ	2	TAILWHEEL BELLEVILLE DISC SPRING - MG13-286

REVISIONS				
E.C. NO.	REV.	DESCRIPTION	BY	DATE
	A	DRAWING RELEASED	SH	8/06
1156	B	UPDATED DRAWING	BH	2/13

ITEM	QTY	DESCRIPTION
A	1	AN4-45A BOLT
B	12	AN960-416 WASHER
C	1	TAILWHEEL SPRING BRACKET SLEEVE - MG03-179
D	2	FLANGED NYLON BEARING - MH06-32
E	1	TAILWHEEL SPRING BRACKET ASSEMBLY - MG01-11
F	7	MS21042-4 LOCKNUT
G	2	AN4-12A BOLT
H	2	AN3-14A BOLT
J	2	TAILWHEEL DOOR LINKAGE SPACER - MF04-353
K	10	AN960-10 WASHER
L	6	MS21042-3 LOCKNUT
M	1	AN4-10A BOLT
N	1	TAILWHEEL SPRING CLAMP - MG01-12
P	2	AN4-5A BOLT
Q	1	TAILWHEEL SPRING - MG01-6
R	1	1" NYLON CAP - MH06-35
S	1	TAILWHEEL MOUNT ASSEMBLY - MG03-144
T	2	FLANGED NYLON BEARING - MH06-34
U	1	TAILWHEEL ARM - MG02-62
V	1	AN3-11A BOLT
W	1	TAILWHEEL SPACER - MG04-186
X	1	TAILWHEEL RETAINER - MG02-48
Y	1	WHITE PTFE FLAT WASHER - MH06-33
Z	1	TAILWHEEL INNER CONTROL HORN ASSEMBLY - MG13-284
AA	2	TAILWHEEL CONTROL HORN WASHER - MG03-166
BB	1	TAILWHEEL OUTER CONTROL HORN - MG02-47
CC	2	AN3-6A BOLT
DD	1	MODIFIED 1/4"-28 X 1-1/2" SS CAP SCREW
EE	1	AN3-23A BOLT
FF	2	AN960-10L THIN WASHER

TITAN AIRCRAFT SUPPLY
 1419 STATE ROUTE 45 SOUTH
 AUSTINBURG, OHIO 44010

DETAIL NAME			
DRAWN	S. HENDERSON	DATE	8/21/06
CHECKED	J.W.	DATE	10/15/18
APPROVED		DATE	
SCALE	1/4" = 1"	PART NO.	
ASSEMBLY NAME	COMPLETE TAILWHEEL ASSEMBLY		
PART NO.	MG03-156	DRAWING NO.	LG10
DRAWING NO.	B T51-06-INS-1522-B		