

REVISIONS

E.C. NO.	REV.	DESCRIPTION	BY	DATE
	A	DRAWING RELEASED	SH	8/06

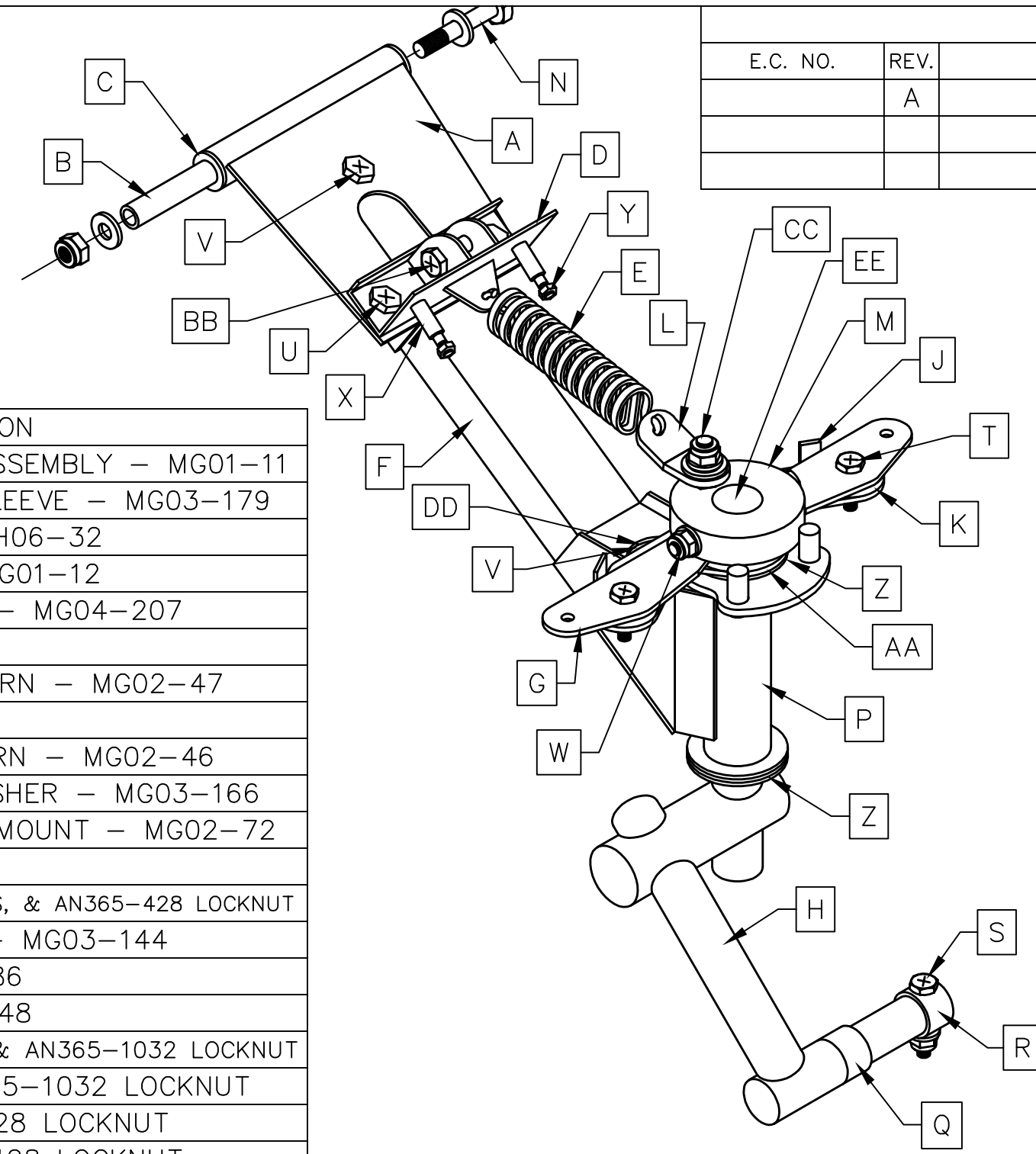

SYMBOLS	# OF PARTS	PART DISCIPTION
A	1	TAILWHEEL SPRING BRACKET ASSEMBLY – MG01-11
B	1	TAILWHEEL SPRING BRACKET SLEEVE – MG03-179
C	2	FLANGED NYLON BEARING – MH06-32
D	1	TAILWHEEL SPRING CLAMP – MG01-12
E	1	TAILWHEEL CENTERING SPRING – MG04-207
F	1	TAILWHEEL SPRING – MG01-6
G	2	TAILWHEEL OUTER CONTROL HORN – MG02-47
H	1	TAILWHEEL ARM – MG02-62
J	1	TAILWHEEL INNER CONTROL HORN – MG02-46
K	2	TAILWHEEL CONTROL HORN WASHER – MG03-166
L	1	TAILWHEEL CENTERING SPRING MOUNT – MG02-72
M	1	TAILWHEEL DRIVER – MG02-53
N	1	AN4-45 BOLT, (2) AN960-416 WASHERS, & AN365-428 LOCKNUT
P	1	TAILWHEEL MOUNT ASSEMBLY – MG03-144
Q	1	TAILWHEEL SPACER – MG04-186
R	1	TAILWHEEL RETAINER – MG02-48
S	1	AN3-11 BOLT, AN960-10 WASHER, & AN365-1032 LOCKNUT
T	2	AN3-6 BOLT, AN960-10, AN365-1032 LOCKNUT
U	2	AN4-5, AN960-416, AN365-428 LOCKNUT
V	2	AN4-12, AN960-416, AN365-428 LOCKNUT
W	1	AN3-22, AN960-10L, AN365-1032 LOCKNUT
X	2	TAILWHEEL DOOR LINKAGE SPACER – MF04-353
Y	2	AN3-14, AN960-10L, AN365-1032 LOCKNUT
Z	2	FLANGED NYLON BEARING – MH06-34
AA	1	WHITE PTFE FLAT WASHER – MH06-33
BB	1	AN4-10 BOLT, AN960-416 WASHER, & AN365-428
CC	1	1/4-28 S.S. CAP SCREW, AN345-416 JAM NUT, (2) AN960-416L WASHER, AN364-428L LOCKNUT
DD	1	1" NYLON CAP – MH06-35
EE	1	POLYETHELENE PLUG – MH06-36

TITAN AIRCRAFT SUPPLY
 1419 STATE ROUTE 45 SOUTH
 AUSTINBURG, OHIO 44010

DETAIL NAME	
SCALE N/A	PART NO.
ASSEMBLY NAME COMPLETE TAILWHEEL ASSEMBLY	
PART NO. MG03-156	DRAWING NO. LG10
DRAWING NO. B T51-06-INS-1522-A	

DRAWN S. HENDERSON	DATE 8/21/06
CHECKED R. INGLE	DATE 8/23/06
APPROVED J. WILLIAMS	DATE 1/2/07

THIS DOCUMENT PROPRIETARY TO TITAN AIRCRAFT, AND IS NOT TO BE USED, CIRCULATED, REPRODUCED, COPIED, OR DISCLOSED IN ANY MANNER WITHOUT PRIOR WRITTEN PERMISSION OF AN AUTHORIZED OFFICIAL OF TITAN AIRCRAFT.