

REVISIONS

E.C. NO.	REV.	DESCRIPTION	BY	DATE
	A	RELEASED DRAWING	SH	6/05
0277	B	PART RE-DESIGNED	SH	5/06
0360	C	PART #'S CHANGED	SH	11/06

NOTE:

- EACH COUNTERWEIGHT (MC06-276) WEIGHS ¾ OF A POUND. (TOGETHER THEY WEIGH 1 ½ LBS.)
 - USE (2) AN3-21A BOLTS, AN960-10 WASHERS, & AN365-1032 LOCKNUTS TO ASSEMBLE. (AS SHOWN)
 - USE SAME PROCEDURE FOR LEFT HAND COUNTERWEIGHT.

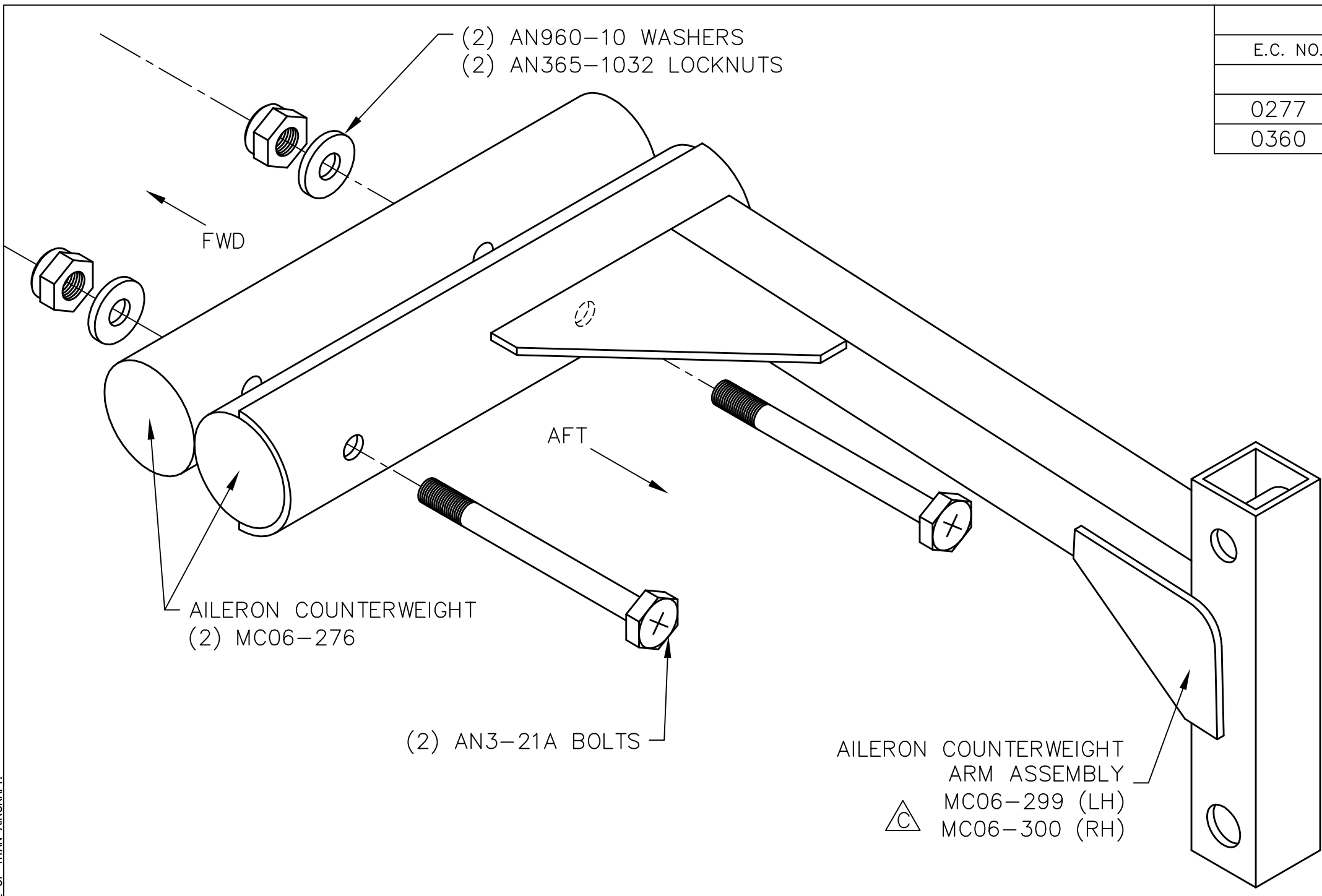

AILERON COUNTERWEIGHT
 ARM ASSEMBLY
 △ MC06-299 (LH)
 MC06-300 (RH)

RIGHT AILERON COUNTERWEIGHT SHOWN
 (COUNTERWEIGHT MOUNTS
 INBOARD OF COUNTERWEIGHT ARM)

THIS DOCUMENT PROPRIETARY TO TITAN AIRCRAFT, AND IS NOT TO BE USED, CIRCULATED, REPRODUCED, COPIED, OR DISCLOSED IN ANY MANNER WITHOUT PRIOR WRITTEN PERMISSION OF AN AUTHORIZED OFFICIAL OF TITAN AIRCRAFT.

TITAN AIRCRAFT SUPPLY
 1419 STATE ROUTE 45 SOUTH
 AUSTINBURG, OHIO 44010

MATERIAL		DETAIL NAME AILERON COUNTERWEIGHT ASSEMBLING INSTRUCTIONAL	
DRAWN S. HENDERSON	DATE 6/21/05	SCALE 1"=1"	PART NO.
CHECKED	DATE	ASSEMBLY NAME	
<p>PRELIMINARY</p>		PART NO.	DRAWING NO.
		DRAWING NO. B T51-05-INS-1159-C	